

08. July 2020

conceaed trap type 300 PC KS, DN 40

Product No. 130273
EAN: 4001636130273
Discount group: 1

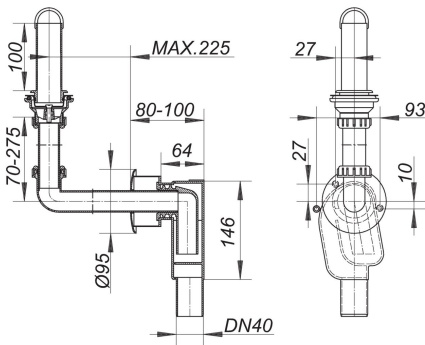

conforming to DIN 19541
for hospital wash basins (e.g. "Paracelus")

- specification:
- space saving built-in trap body
 - height adjustable inlet
 - escutcheon
 - waste
 - c.p. standpipe
 - removable trap insert

material:
trap in polypropylene

inlet white polypropylene, escutcheon white ABS

Product No.	Description	Dimensions
170156	stand pipe, ABS chromed, 100 mm	100 mm
143020	trap insert for 300, 310	