

washing machine or dishwasher trap HL 400 E, DN 40/DN 50

Product No. 130419
EAN: 4001636130419
Discount group: 1

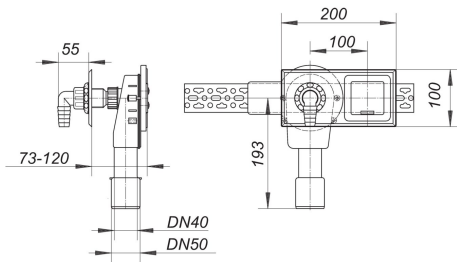

- specification:
- compact recessed body
 - adjustable depth threaded inlet
 - inlet hose connector, chrome
 - sound-absorbing backing plate
 - fixing bracket
 - incorporating power socket with hinged cover
 - cover plate stainless steel, 100 x 200 mm
 - recess depth 73 - 120 mm
 - spacer

material:
polyethylene trap-body for welding HDPE
tested by: VDE (electrical connection)

If installed with only sound insulated contact against the building structure, the requirements of all classes of sound proofing confirming to DIN 4109.10, table 1 and 2 are fulfilled.

Cover plates and on/off valves can be colour-coated to customers choice.

Product No.	Description	Dimensions
140135	cleaning-eye cap for HL 400	
140173	hose connector 90° for concealed traps HL 400/405/406, chromed, 1"	1"
090324	hose connector 90°, for concealed traps HL 400/405/406, grey, 1"	1"
090348	hose connector 90°, for concealed traps HL 400/405/406, white, 1"	1"
140166	lock nut for 400/405/406, chromed, 1"	1"

13. calendar_month_january 2020

DALLMER

140142	lock nut for 400/405/406, grey, 1"	1"
140159	lock nut for 400/405/406, white, 1"	1"