

06. November 2020

**DALLMER****floor drain type 30 PRIMUS E 12, DN 50, 120 x 120 mm**

Product No. **405333**  
 EAN: 4001636405333  
 Discount group: 3

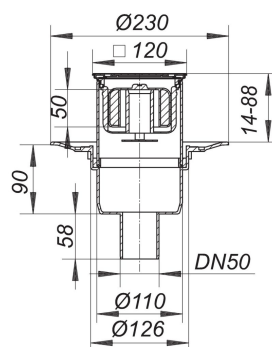

Seals when water dries out!  
 outlet DN 50 vertical

**specification**

- 50 mm bell trap and mechanically sealing device
- height adjustable grating E 12
- temporary blanking plate

**material**

polypropylene

frame 304 stainless steel, 120 x 120 mm, grate 304 stainless steel, load class  
 K 3 (300 kg)

The outlet connector can be supplied in ABS to suit British Standard sizes and PE-HD conforming to DIN EN 1519. Please enquire.

Fire protection system 2 (Part No. 515025) applicable.

Flow rate tested to DIN EN 1253 Tab. 3,  
 (with 20 mm water over cover plate), conforming to DIN EN 274

	Norm	DALLMER
DN 50	0.4 l/s	0.5 l/s

Product No.	Description	Dimensions
495006	trap insert Primus, 50 mm, for frames 120 x 120 mm	

06. November 2020

**DALLMER**

Product No.	Description	Dimensions
515025	fire and sound-insulating collar - installation kit 2, DN 50	DN 50