

06. November 2020

floor drain type 57 KE, DN 50/DN 70, 150 x 150 mm

Product No. **571274**  
EAN: 4001636571274  
Discount group: 3

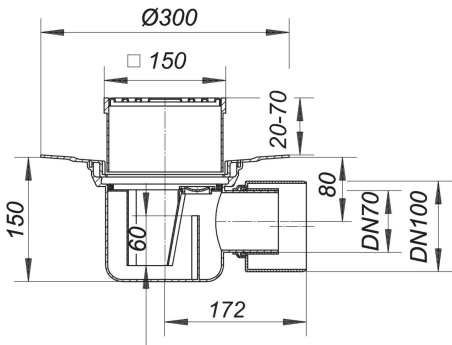

conforming to DIN EN 1253  
outlet DN 70/DN 100 horizontal

- specification
- height adjustable grating KE 15
  - trap with 50 mm water seal (conforming to DIN EN 1253)
  - rodding eye\*
  - temporary blanking plate

material  
polypropylen  
frame polypropylene, 150 x 150 mm, grate 304 stainless steel grate, class K 3 (300 kg)

\* Access to trap and outlet via rodding eye.  
DN 70 connects to BS4514 75 mm pipework with 880345 adaptor.

Flow rate tested to DIN EN 1253  
(with 20 mm water over grate)

	Norm	DALLMER
DN 70	0.8 l/s	1.47 l/s
DN 100	1.4 l/s	1.67 l/s

Product No.	Description	Dimensions
501110	grate E 140, 140 x 140 mm	140 x 140 mm

06. November 2020

**DALLMER**

---

590053	trap insert for 57, 57 AK , 58
--------	--------------------------------

---

Product No.	Description	Dimensions
590091	centralising ring for drain bodies type 54, 55, 57, 58, 61	