

06. November 2020

floor drain type 61 HT/KE, DN 50/DN 70, 150 x 150 mm

Product No. 611253
EAN: 4001636611253
Discount group: 3

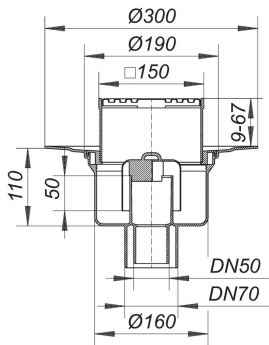

conforming to DIN EN 1253
outlet vertical, for connection to plastic pipework

specification
– height adjustable grating KE 15
– removable trap insert, 50 mm water seal (conforming to DIN EN 1253)
– temporary blanking plate

material
polypropylene
frame polypropylene, 100 x 100 mm, grate 304 stainless steel, load class K 3 (300 kg)

DN 70 connects to BS4514 75 mm pipework with 880345 adaptor.

Flow rate tested to DIN EN 1253
(with 20 mm water over grate)

	Norm	DALLMER
DN 50	0.8 l/s	1.78 l/s
DN 70	0.8 l/s	1.97 l/s

Product No.	Description	Dimensions
590077	bell trap for drain body 61	
590091	centralising ring for drain bodies type 54, 55, 57, 58, 61	
611055	Floor drain body type 61 HT, DN 50/DN 70	DN 50/DN 70

06. November 2020

DALLMER

500670	frame K 15, 150 x 150 mm	150 x 150 mm
501110	grate E 140, 140 x 140 mm	140 x 140 mm

Product No.	Description	Dimensions
693006	Back flow seal CeraDrain S 15	
591005	extension S 15	
591012	extension S 15, side inlet DN 40	
515018	fire and sound-insulating collar - installation kit 1, DN 50/DN 70	DN 50/DN 70
562005	raising piece type 550 DallBit S 15	
560001	raising piece type 550 with sealing kit S 15	
560018	raising piece type 550 without sealing kit S 15	
560506	sealing kit S 15	
790125	waterproofing collar S 15, EPDM, d: 500 mm	d: 500 mm
790118	waterproofing collar S 15, flexible PVC, d: 500 mm	d: 500 mm