

## floor drain DallDrain Select vertical OM, DN 50/DN 100, 120 x 120 mm

Part number: 517661  
 GTIN: 4001636517661  
 Rebate group: 6

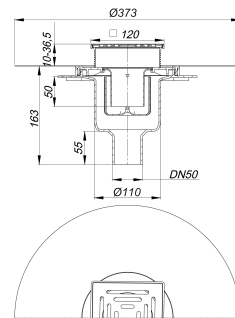

### Description:

floor drain DallDrain Select vertical OM, DN 50/DN 100, 120 x 120 mm conforming to DIN EN 1253  
 Floor drain including grating DallDrain Select with stainless steel grate in stainless steel frame. Outlet DN 50/DN 100 vertical.

#### Specification

- Stainless steel grate and frame
- Integrated screed anchoring
- Flexible, click-in sealing sleeve for secure connection to bonded and sheet waterproofing conforming to DIN 18534
- Fully removable, two-piece trap insert and rodding eye, 50 mm water seal (conforming to DIN EN 1253)
- Temporary blanking plate
- Spigot can be shortened for floorings 10 – 36 mm (including adhesive)

#### Material

Polypropylene drain body and outlet, highly impact-resistant; 1.4301 stainless steel grate, load class K 3 (300 kg); spigot in ABS, frame in 1.4301 stainless steel

Pre-assembled set consisting of parts no. 517296 + 517234.

Grating with positioning aid laterally adjustable +/- 9.5 mm.

Fire and sound-insulating collar - installation kit 2 (Part No. 515025) or

fire protection kit 12 (Part No. 515438) applicable.

### Flow rates tested to DIN EN 1253:

| Nominal diameter | Product standard | Min. flow rate according to norm | Water level according to norm | Flow rate at water level 10 mm | Flow rate at water level 20 mm |
|------------------|------------------|----------------------------------|-------------------------------|--------------------------------|--------------------------------|
| DN 50            | DIN EN 1253      | 0.80 l/s                         | 20.00 mm                      | 0.72 l/s                       | 1.30 l/s                       |