

yard drain type 616.0, DN 150

Part number: 861092
 GTIN: 4001636861092
 Rebate group: 3

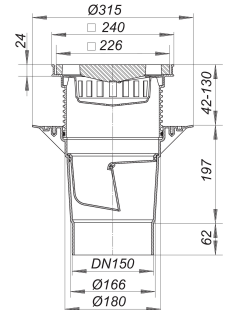

Description:

yard drain type 616.0, DN 150

With 500 x 500 mm collar of 5.0 mm thick bituminous membrane, welded to the flange and secured with stainless steel clamp ring.
 outlet vertical

specification

- flange
- frost-proof self-closing flap-valve
- removable bucket
- height adjustable and rotatable grating

material

polypropylene

ductile iron grate, load class A (up to 1,5 t)

Fire protection system 4 (Part No. 515049) applicable.

Flow rates tested to DIN EN 1253:

Nominal diameter	Product standard	Min. flow rate according to norm	Water level according to norm
DN 150	DIN EN 1253	8.10 l/s	45.00 mm

Spare parts:

860996 ductile iron grate for 605/606/615/616